



Artist's impression

Turnkey Inclusions 2024

- Upgraded Gas Cooktop with Wok Burner and 900mm Rangehood.
- Actron dual zone ducted reverse cycle heating/cooling system.
- Latest in hybrid flooring (heat, stain, water and bacteria resistant).
- Built-in mirrored sliding storage.
- LED downlights throughout kitchen & bathroom areas.
- 20mm reconstituted stone benchtops with soft close drawers (in accordance with selected colour scheme).
- Sectional overhead Colorbond garage door with auto-opener (2 hand-held transmitters and 1 wall-mounted transmitter).
- Landscaping to front and rear yards, boundary fencing, concrete driveway, letterbox and clothesline.

 4
  2
  1

| | |
|--------------|---------------------------|
| LOT | 270m ² |
| GROUND | 119m ² |
| TOTAL | 147.4m² |

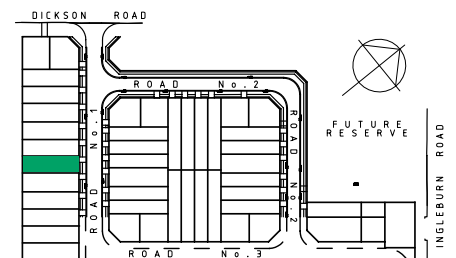

 4
  2
  1

| | |
|--------|---------------------|
| LOT | 270m ² |
| GROUND | 119m ² |
| TOTAL | 147.4m ² |

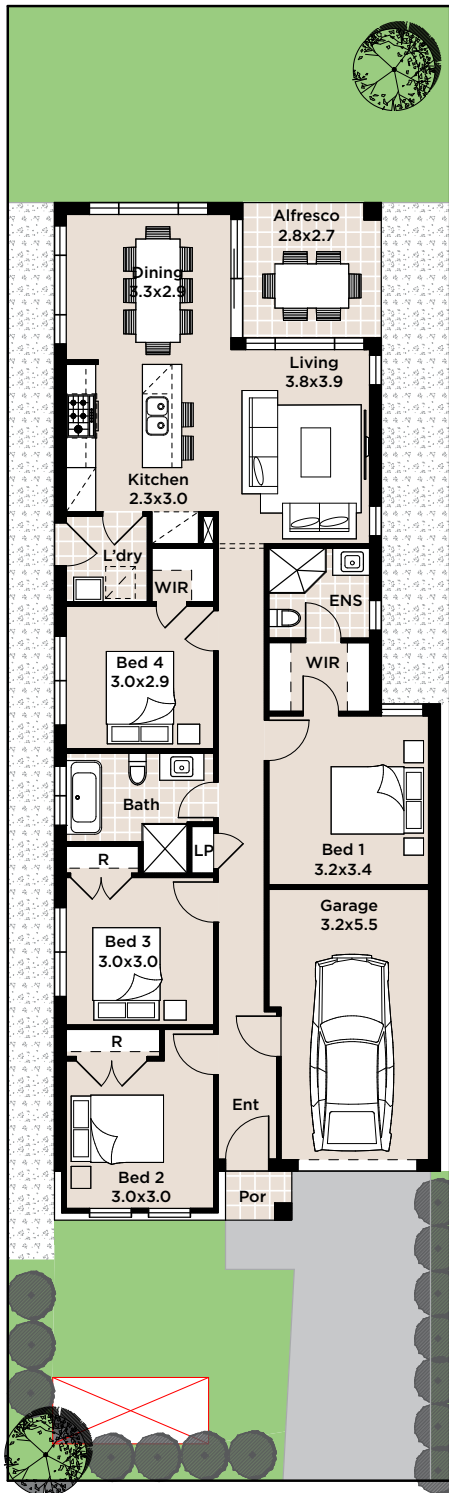

PROPOSED ROAD NO. 1